

O3 HYDRO 5

USER MANUAL

TABLE OF CONTENT

1. Safety Precautions	1
2. Device Identification	3
3. System Overview	7
4. Getting Started	8
5. Basic Maintenance	15

SAFETY PRECAUTIONS

WARNINGS - *To reduce the risk of electrical shock, fire or injury:*

1. Do not use the device if the power cable or plug is damaged.
2. Do not insert any sharp or pointed object through the ventilation holes of the device.
3. Do not let unauthorized personnel to play with the device.
4. Do not immerse the device in water, or allow water or any fluids to enter through the ventilation holes.
5. When removing the power plug, always hold the plug and never pull the cable.
6. Do not remove the power plug when your hands are wet.
7. Remove the power plug from the wall socket before cleaning the device.
8. Do not modify, disassemble or repair this device without proper training unless stated in the manual.
9. Do not replace the electric plug or cut the power cable. Replacing the plug or cutting the power cable in any way will immediately cause the Warranty to become void. Any subsequent fault in the operation of the device will not be covered by the Warranty, and repair and servicing will be chargeable.
10. If the power cable is damaged, contact an authorized Medklinn Service Centre for repairs immediately.
11. Do not attempt to open the inner compartment of the device. The device requires minimal maintenance, and no servicing or repairs are to be carried out by the User. Opening the device or tampering with it in any way will cause the Warranty to become void. If you encounter any problems with the device, please contact the nearest authorized Medklinn Service Centre.
12. Do not wipe the device with benzene or paint thinner.

FOR FURTHER ASSISTANCE, PLEASE CALL OUR CUSTOMER SERVICE.

NOTE – Radio, TV or sensitive equipment Interference:

If the device should cause interference to radio, television reception or any sensitive equipment, try to correct the interference by one or more of the following measures:

- Reorient or relocate the receiving antenna.
- Increase the distance between the device and radio/TV receiver/sensitive equipment.
- Connect the device into an outlet on a circuit different from that to which the receiver is connected.
- Consult the dealer or an experienced radio/TV technician for help.

Cautions during operation:

1. Place the device at least 6 feet from radio, television or electronic equipment. This is to minimize the possibility of interference with the equipment or the remote controller.
2. Do not cover the device in any way at all, particularly the ventilation holes. Doing so will cause excessive heat build-up and may result in a fire and irreparable damage to the device.
3. Avoid placing the device where curtains or other furnishings may cover the ventilation holes.
4. Avoid placing the device in an oily environment as it may cause the module to be coated with a thicker layer of grease/debris. Hence, affecting its performance.
5. Ensure that there is free flow of air around the device.
6. Avoid locations where the device is exposed to condensation due to rapid and drastic temperature fluctuations. The device should only be used in temperatures between 10°-35°C.

Device Identification

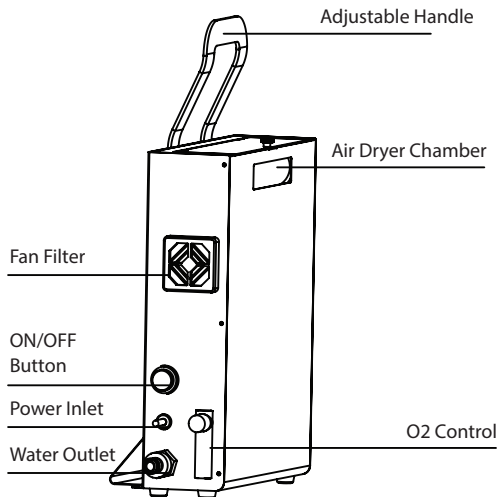

Medklinn O3 Hydro 5 (Left Side View)

Functional parts

Air Dryer Chamber	Removes moisture from the air supply before it goes into the ozone module
Fan Filter	Filters dust from entering the fan and inner compartment
ON/OFF Button	To switch the device ON/OFF
Water Outlet	Ozone water flows out from here
O2 Control	Controls the amount of oxygen flowing into the device's ozone module

Device Identification

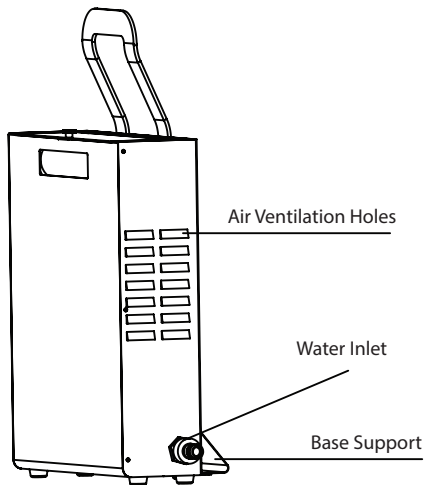

Medklinn O3 Hydro 5 (Right Side View)

Functional parts

Water Inlet	Water supply flows into here
Base Support	Attach to give better stability to the device

Device Identification

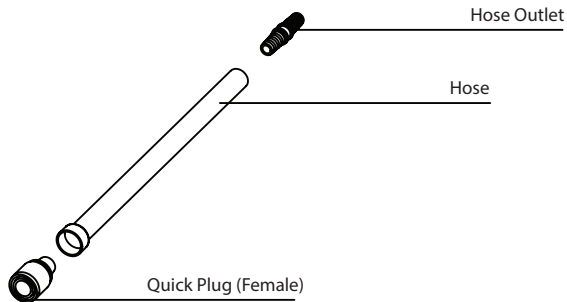

Medklinn O3 Hydro 5 Accessories (Hose 1)

Functional parts

Hose Outlet:	Focuses the spray pattern of the water
Quick Plug (Female):	Secures the hose to the water source and/or device

Device Identification

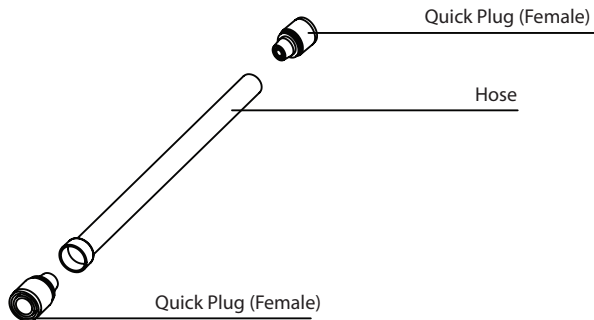

Medklinn O3 Hydro 5 Accessories (Hose 2)

Functional parts

Quick Plug (Female):	Secures the hose to the water source and/or device
-----------------------------	--

System Overview

Medklinn O3 Hydro 5 converts supplied oxygen (O₂) into ozone (O₃) and infuses it into the water.

The ozone water

- Disinfects and deodorizes surfaces without hot water
- Eliminates bacteria, viruses and mould
- Removes and prevents biofilm build-up
- Dissolves oil and grease

When the Medklinn O3 Hydro 5 operates, the air is drawn into the air dryer chamber, which dries the air. The dry air is supplied to the ozone module which breaks it down to ozone (O₃) with the use of electricity. It is then infused into the water through a venturi injection to generate ozone water.

Getting Started: Connecting the hose

Using Quick Plug

1. Connect a Quick Plug (Male) to the water source pipe with male threaded end.

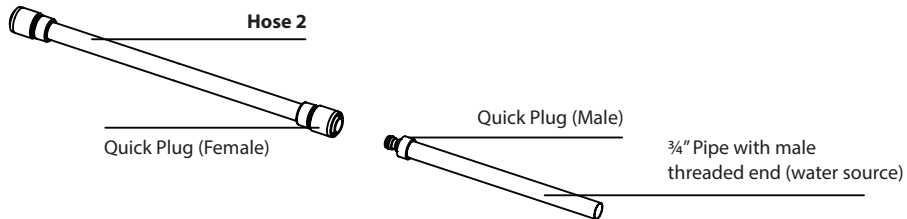

NOTE: Make sure that there is enough Teflon tape when attaching the Quick Plug (Male) to the threaded end of the pipe to avoid leakage at that point

2. Pull the yellow cap of the Quick Plug (Female) while connecting to the Quick Plug (Male). Release the cap to secure the connection. There should be a “click” sound when the Quick Plugs are secured together. Pull the hose gently to confirm that the connection is indeed secured.

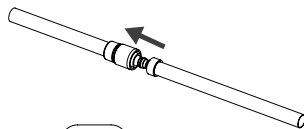

3. Connect the other Quick Plug (Female) of Hose 2 to the device's Water Inlet.

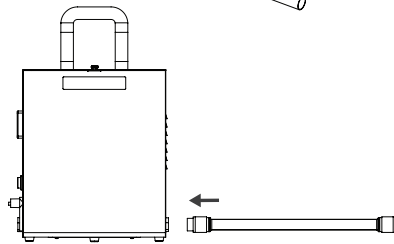

4. Connect the Hose 1 Quick Plug (Female) to the device's Water Outlet.

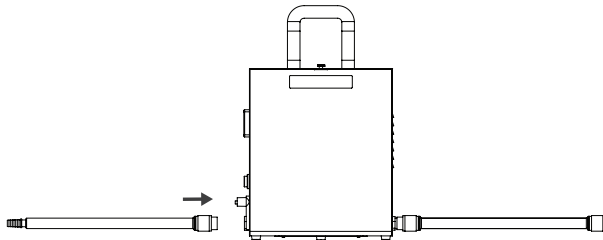

To a water tap

1. If you have a water tap, please remove one end of the Hose 2 Quick Plug (Female) by loosening the cap.

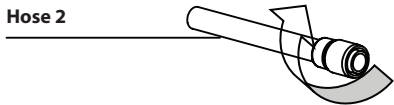

2. Pull out the Quick Plug.

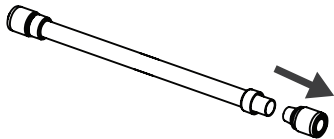

3. Connect the hose to the water tap with a hose clip. Tighten the hose clip with a screwdriver. Ensure it is tight so that water will not leak out when the tap is turned on.

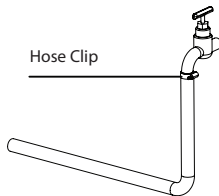

4. Connect the other Quick Plug (Female) of Hose 2 to the device's Water Inlet.

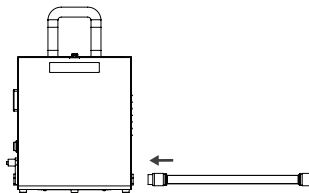

5. Connect the Hose 1 Quick Plug (Female) to the device's Water Outlet.

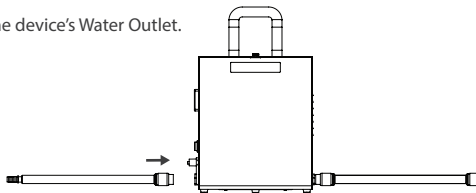

Getting Started: Turn on the device

1. Plug the power inlet to the AC power supply.
2. Connect both hoses provided to the device (Refer to "Getting Started: Connecting the hose", page 8).
3. Turn on the water supply.
4. Turn on the ON/OFF button.
5. Make sure that the flow rate of the O2 Control is between 1- 1.5 lpm.

Getting Started: Controlling the ozone level into the water

The Medklinn O3 Hydro 5 ozone level is controlled by turning the knob of the O2 Control to increase or decrease the level ozone generation. It is advisable to keep the flow rate between 1 - 1.5 lpm.

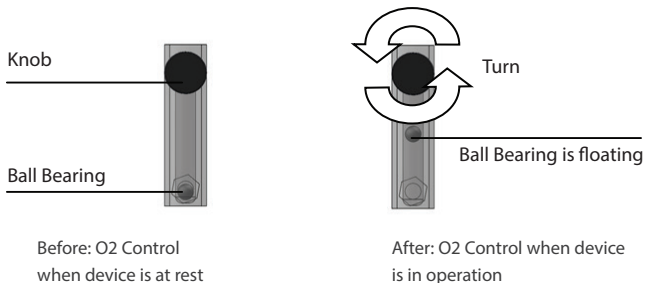

Getting Started: Installation of Device

Option A: Wall mount

1. Mount a pair of wall plugs with M3 screws to the wall.

NOTE: Leave a distance of 1.5 cm screw length from the wall. Do not screw all the way in. The length allows the device to be hooked on safely.

2. Hook the Medklinn O3 Hydro 5 mounting slots onto the screws.

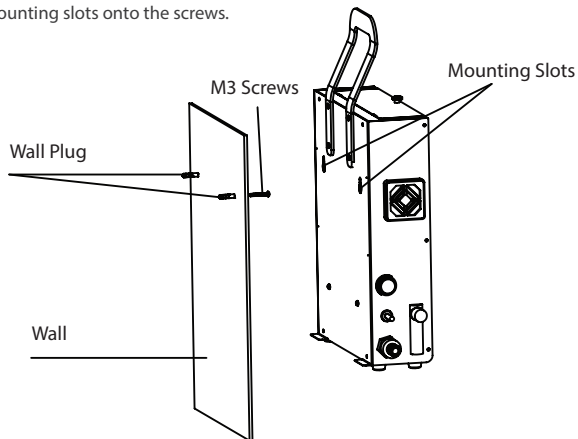

Option B: Table top

1. Remove the 4 pieces of M4 screws from the device (2 at the back, 2 at the bottom)
2. Align and secure the Base Support to the device using the same 4 screws.

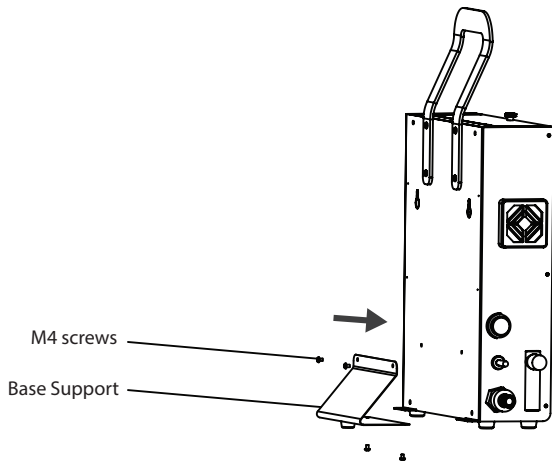

Basic Maintenance

Cleaning the Fan Filter

1. Turn off the AC power outlet. Make sure the light at the ON/OFF Button is not lit.
2. Remove the Fan Filter by pulling out the Filter Cover.

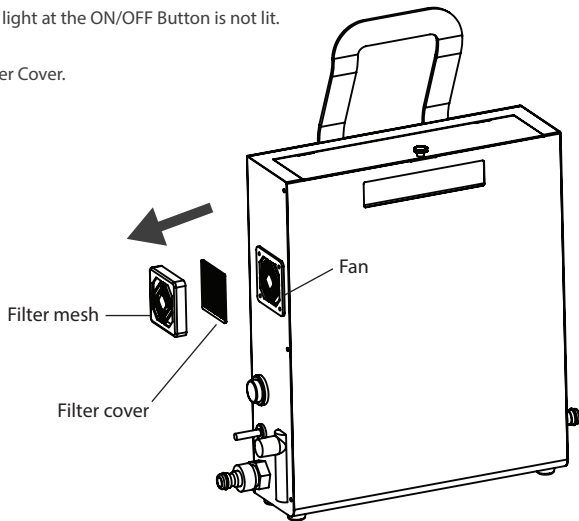

3. Brush the Filter Mesh with a soft bristle brush. Rinse and dry the Filter Cover. Wipe the Fan gently with a dry cloth.

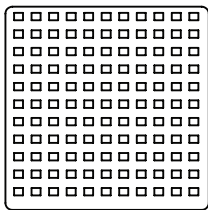

Filter Mesh

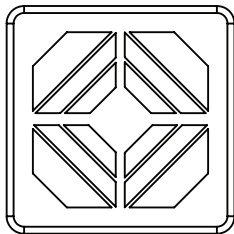

Filter Cover

4. Assemble the Fan Filter in proper order and reattach it to the Fan.
5. Clean the Fan Filter once a month or when it is clogged up with dirt/dust which may block the Fan from functioning.
(A clogged up filter will damage the fan)

For more information, please log on to www.medklinn.com

